

Regional Overview

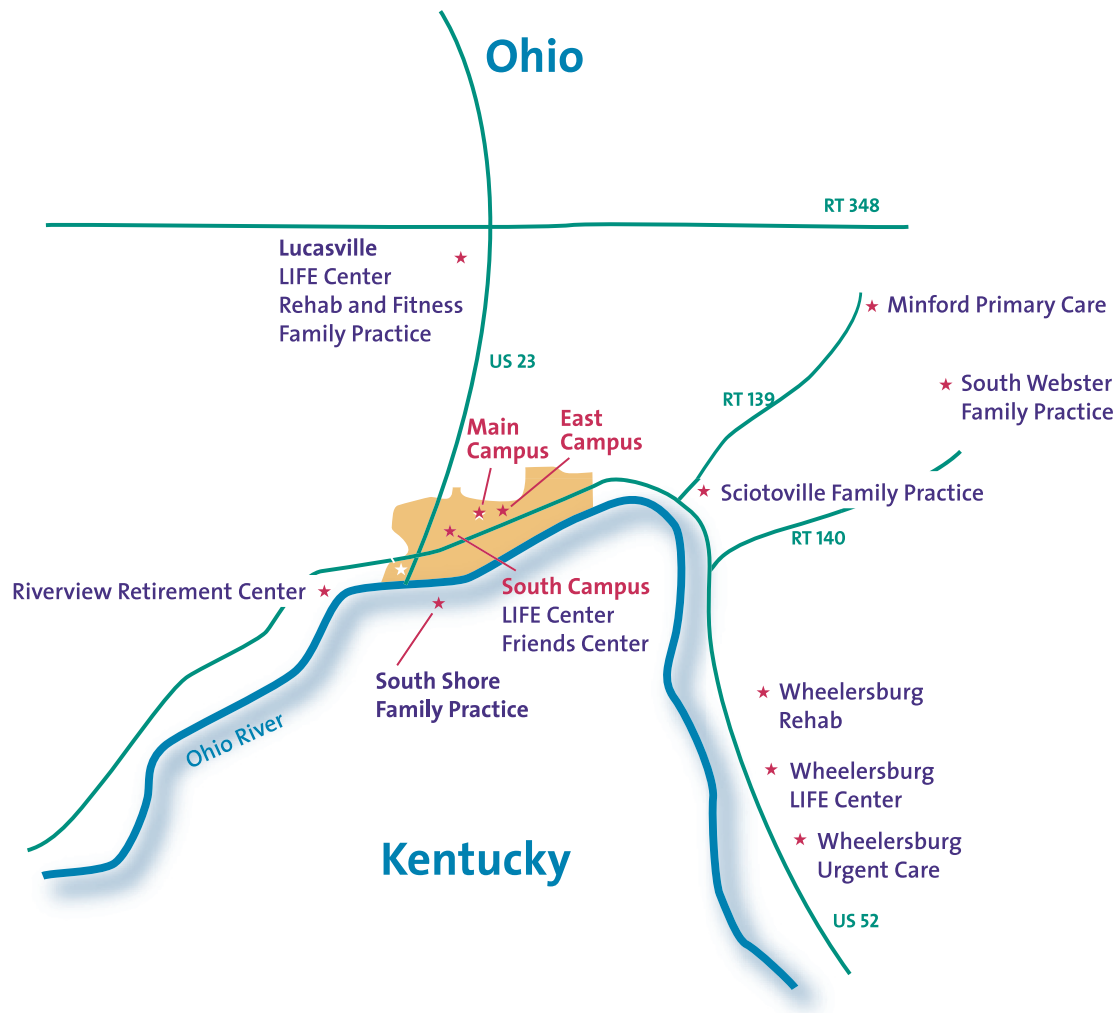

SOMC delivers care to and services for our community at our three campuses, minutes from each other, and through multiple extended site locations in order to increase access and adjust for our rural surroundings:

Main Campus: 221-bed acute care hospital, four MEDICAL OFFICE BUILDINGS (MOBs) and Wound and Sleep centers;

East Campus: SOMC Hospice Center, linen services, and administrative offices;

South Campus: SOMC Health Care Center (non-trauma emergency center); SOMC Cancer Center; Occupational Medicine; LIFE CENTER fitness facility (for workforce and community); outpatient rehabilitation services; employment office; and administrative offices;

Downtown Campus: Home Care offices;

Satellite Facilities: Urgent Care Center (Wheelersburg), LIFE CENTER with satellite rehabilitation centers (Wheelersburg and Lucasville), and six Medical Care Foundation physician offices in outlying sections of Scioto County and northern Kentucky

Southern Ohio Medical Center

Very Good things are happening here

Driving Directions to Campuses

SOMC Main Campus is located at 1805 27th Street.

Coming south on US 23:

When coming south on US 23, within the city limits, turn left at the first light onto Coles Boulevard and proceed to 27th Street, turn right into the Main Campus entrance.

From East or West:

Coming from US 52 East or West, turn on US 23 North, turn right onto Coles Boulevard. Turn right onto 27th Street into the Main Campus entrance. ALTERNATE: from US 52, turn north on Grandview Avenue, turn left on either 25th or 27th Street into the Main Campus.

From the SOMC South Campus:

From the South Campus, take 18th Street, turn left on Oakland, turn right on Kinneys Lane, travel to Grandview Ave. Turn left on Grandview, turn left on either 25th or 27th Street, which leads into the SOMC Main Campus.

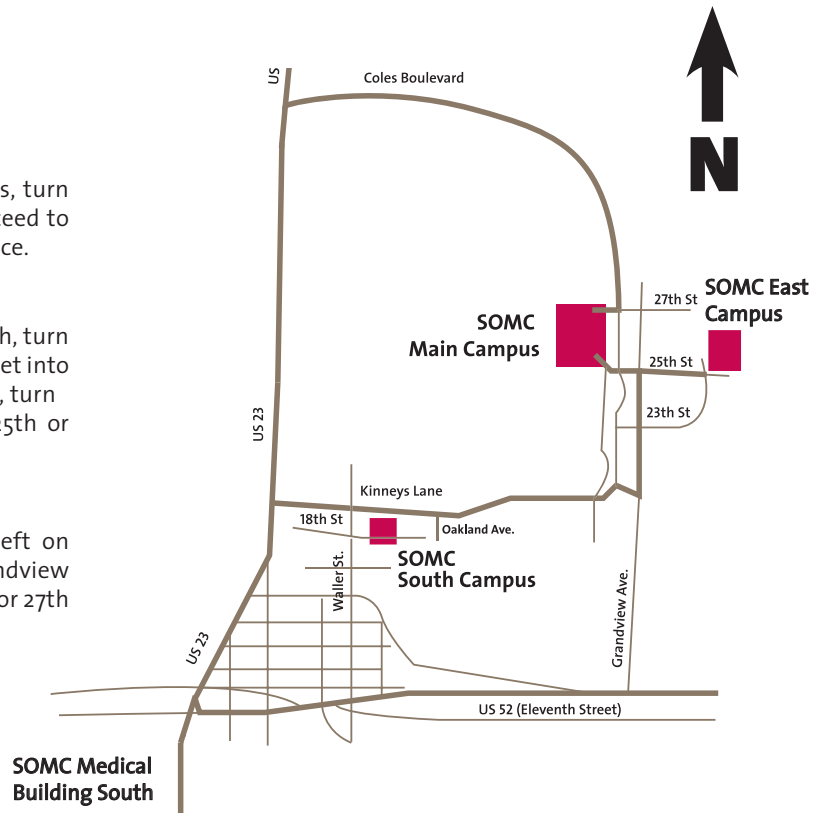

SOMC South Campus is located at 1248 Kinneys Lane.

Coming south on US 23:

When coming south on US 23, turn left onto Kinneys Lane, travel one block, turn right onto Waller Street and left on 18th Street. Parking is on the left adjacent to the Health Care Center or on the right beyond the SOMC LIFE Center and Friends Community Center.

From East or West on US 52:

From US 52 turn on US 23 North, turn right on Kinneys Lane and follow the directions above.

To SOMC Main Campus from South Campus:

Take Oakland Avenue north, turn right on Kinneys Lane, turn left on Grandview Avenue and left on 27th Street into the Main Campus.

SOMC East Campus is located at 2201 25th Street.

From North or South

When coming north or south on US 23, within the city limits, turn onto Coles Boulevard and proceed to 25th Street, turn left (east) and pass Grandview Avenue, Summit on the right and Ka-Lyn on the left, Elmwood Drive and turn left into the parking lot.

From East or West

Coming from US 52 East or West, turn on US 23 North, turn right onto Coles Boulevard. Proceed to 25th Street, turn left (east) and pass Grandview Avenue, Summit on the right and Ka-Lyn on the left, Elmwood Drive and turn left into the parking lot.

Main Campus

1805 27th Street, Portsmouth, OH | 740| 356-5000

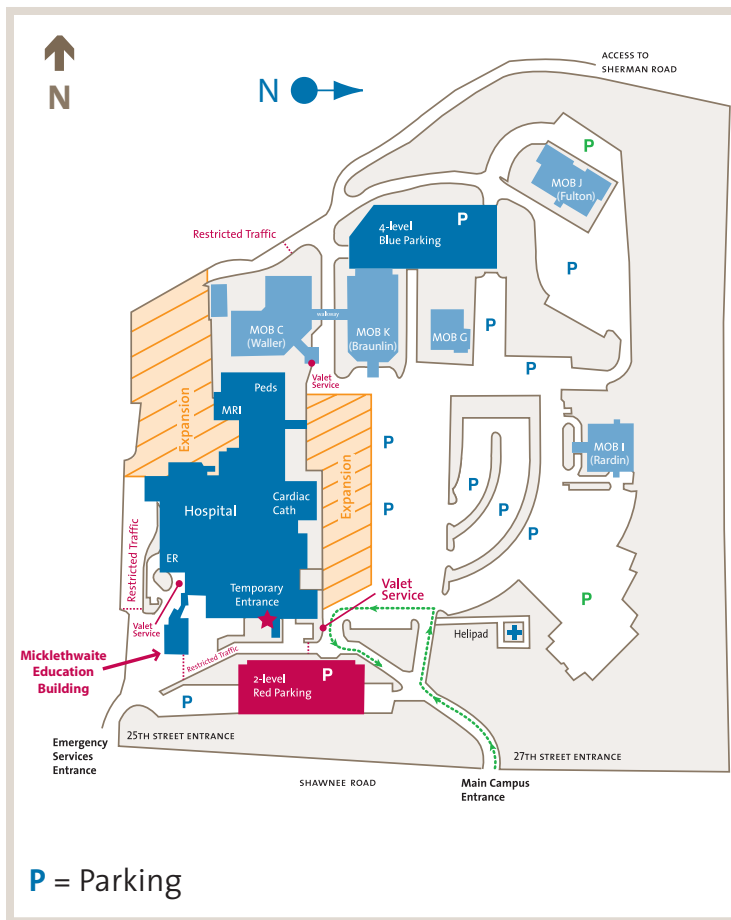

Physician Directory

Waller Building (Former Building C)

Sadiq Al-Nakeeb, MD
 Carolyn Arnett, DO
 Reshma Banerjee, DO
 Philip Bates, MD
 Wasim Deeb, MD
 George Esham, MD
 Ammar Ghanem, MD
 Murthy Gollamudi, MD
 Lori Guinn, MSW
 Travis Hodgdon, DO
 Heather Horton, MD
 Rajesh Kataria, DO
 Samer Kseibi, MD
 Duane Marchyn, MD
 Kathy Marks, MD
 Michael Martin, MD
 Richard Rooney, MD
 Elie Saab, MD
 Christopher Schmidt, DO
 Rebecca Schoettle, MD
 Gerardo Trinidad, MD
 Kim Umhoefer, DO
 Roger Wittum, MD
 Charles Wong, MD

Building G

George Pettit, MD
 Jennifer Roberts, DO

Braunlin Building (Former Building K)

Ernesto Banalagay, MD
 Thomas Khoury, MD
 Reena Samuel-Variath, MD
 Vincent Scarpinato, MD
 Robert Schrimpf, MD

Fulton Building (Former Building J)

Darren Adams, DO
 Ron Arrick, MD
 Suzann Bonzo, MD
 William Esham, MD
 Jeffrey Hill, DO
 Kevin Kammler, DO
 James Mullins, MD
 Yong Song, MD
 Terrence Welsh, MD

Key Destinations on Main Campus

Emergency Department
 Heart & Vascular Services
 Cardiac Catheterization
 Cardiac Testing
 Inpatient Rehabilitation
 Maternity
 Medical Imaging
 Computerized Tomography (CT) Scan
 Magnetic Resonance Imaging (MRI)
 Nuclear Medicine
 Radiology/X-Ray
 Outpatient Laboratory
 Pediatrics
 Sleep Diagnostic Center (Building I)
 Surgical Services
 Same Day Surgery
 Surgery
 Wound Healing Center (Building I)

Building Directory

Rardin Building (MOB I)
 SOMC Wound Healing Center
 SOMC Sleep Diagnostic Center
 Diabetes Education

Driving Directions to Main Campus

When coming south on US 23, within the city limits, turn left (*if coming north on US 23 turn right*) onto Coles Boulevard and proceed to 27th Street, turn right into the Main Campus entrance.

From the South Campus, take 18th Street, turn left on Oakland, turn right on Kinneys Lane, travel to Grandview Avenue. Turn left on Grandview, turn left on 27th Street, which leads into the SOMC Main Campus.

Coming from US 52, turn on US 23 North, turning right (east) onto Coles Boulevard. Turn right onto 27th Street.

Main Campus Destinations & Directions

Free Valet Service

Parking attendants are on hand in front of the Main and the Braunlin Building entrances during daytime weekday hours and all hours every day at the Emergency Department Entrance. Please feel free to use these services when coming to the Main Campus.

Micklethwaite Education Building

Enter the Main Campus Entrance at 27th Street and park in the two-story Red Parking Garage or in front of the hospital. The Micklethwaite Education Building is located on the southeast corner of the hospital.

Hospital

During the construction of our new lobby, the Main Entrance is temporarily located at the east end of the hospital, with large canopies, seating and valet services. Please use the valet or park in any available visitor parking in front of the hospital or in the two-story Red Parking Garage. Additional visitor parking is available beyond the the helipad and in the Blue Parking Garage.

Waller & Braunlin Buildings

The Waller and Braunlin buildings are located west of the hospital. Valet services are available daytime weekdays at the Braunlin Building, or easy access is available via the third-floor walkway leading to the Braunlin and Waller buildings and the Blue Parking Garage.

To reach the valet service, enter at 27th Street, up the hill, slight right, straight to the stop sign and turn left, pass Braunlin and turn right. The valet station and entrance to the Waller Building are on the right. Continue straight and turn right to enter the Blue Parking Garage. ALTERNATE: coming east on Coles Boulevard, turn right on Sherman Road, which will lead into the west side of the Main Campus. Turn left into the Blue Parking Garage or proceed to the valet station on the right.

Fulton Building

The Fulton Building is located at the far west side of the Main Campus on top of the hill. Coming east on Coles Boulevard, turn right on Sherman Road, which will lead into the west side of the Main Campus. Turn left at the access road leading up the hill. Visitor parking is in front of the Fulton Building beyond the Blue Parking Garage. ALTERNATE: enter at 27th Street, up the hill, slight right, straight to the stop sign and turn right. Proceed up the winding hill to the left and parking is in front of the Fulton Building.

Rardin Building

The Rardin Building, the location of the Wound Healing Center and Sleep Diagnostic Services, is located at the north side of the Main Campus. From the 27th Street Entrance, proceed up the hill to the right and turn right at the first parking lane by the helipad. Visitor parking is adjacent to the building.

Main Campus Floor Directory - Ground & First Floors

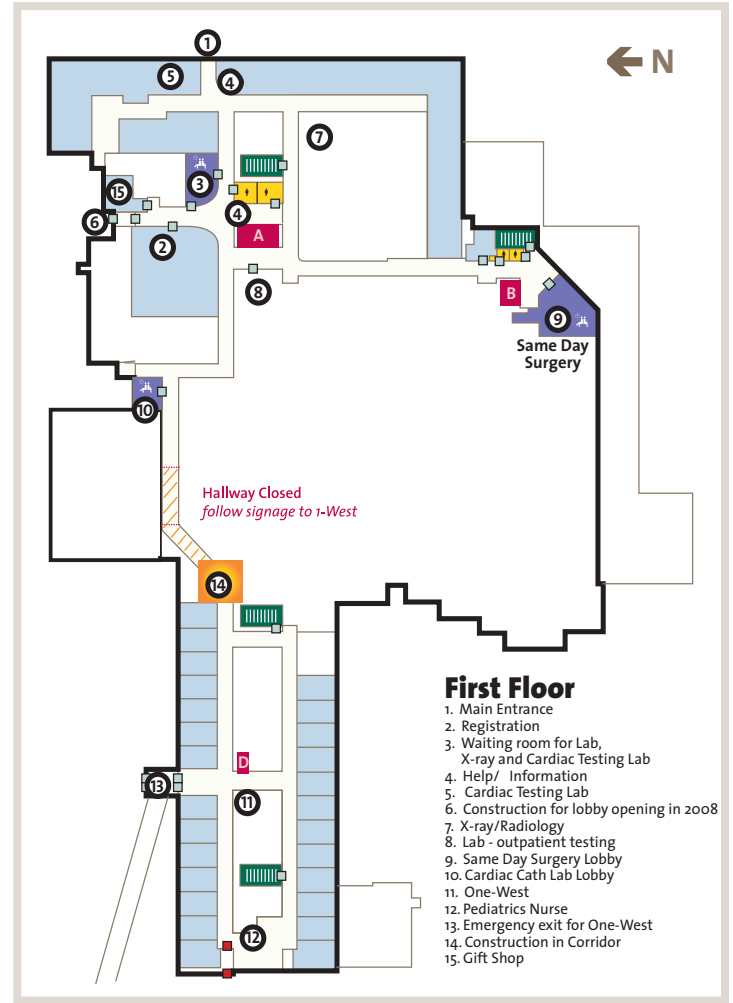
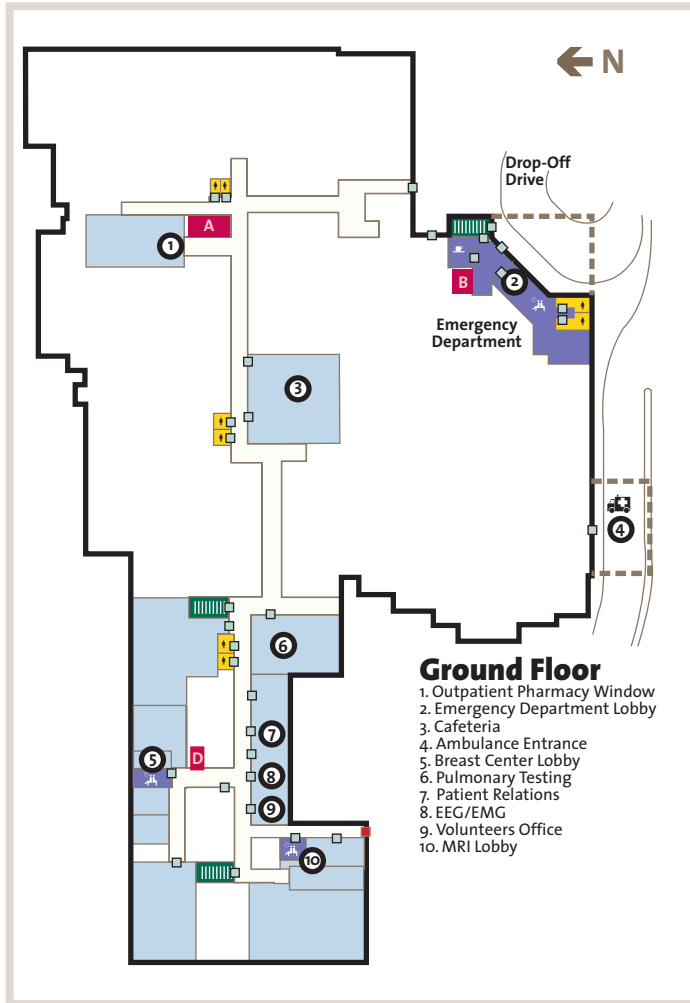

	Restroom		Waiting Room		Public Hallway		Stairwell		Ambulance Entrance
	Elevator		Department		Vending Machine		Telephone		Information

To the Cafeteria

Our cafeteria is located on the ground floor. To reach the cafeteria from Emergency, Same Day Surgery, ICU or Maternity lobbies, take Elevator B to the first floor. Follow the public hallway (shown in yellow on the map) to Elevator A. Take the elevator down to the ground floor. Follow the hallway straight to the cafeteria. Visitor hours in our cafeteria are as follows:

Full service Breakfast	6 am - 9 am
Grab-and-go items	9 am - 11 am
Full-service Lunch	11 am - 2 pm
Grab-and-go items	2 pm - 4 pm
Full-service Dinner	4 pm - 6:30 pm
Closed	6:30 pm - 1 am
Full-service Meals	1 am - 3 am
Closed	3 am - 6 am

To the Gift Shop

Our gift shop is located near Registration on the First Floor. To reach it from the Emergency, Same Day Surgery, ICU or Maternity lobbies, take Elevator B to the first floor. Follow the public hallway to Elevator A. Turn right past the elevator, then left next to Registration. The gift shop will be on your right. The gift shop is open:

Monday - Saturday	10 am - 8 pm
Sunday	1 pm - 8 pm

To the Pharmacy

To reach the Pharmacy, take Elevator B to the first floor. Follow the public hallway to Elevator A. Take Elevator A to the ground floor. The Pharmacy window is to your right as you step out of the elevator.

Main Campus Floor Directory - Second & Third Floors

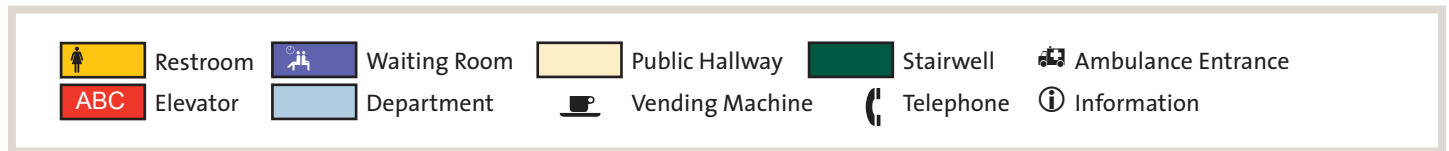
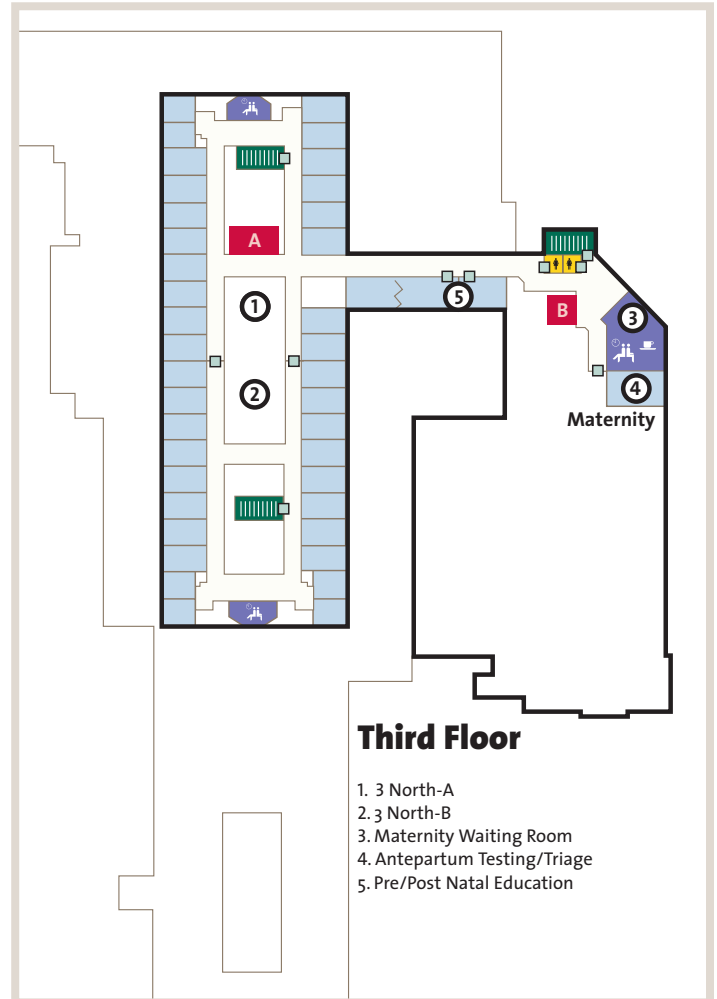
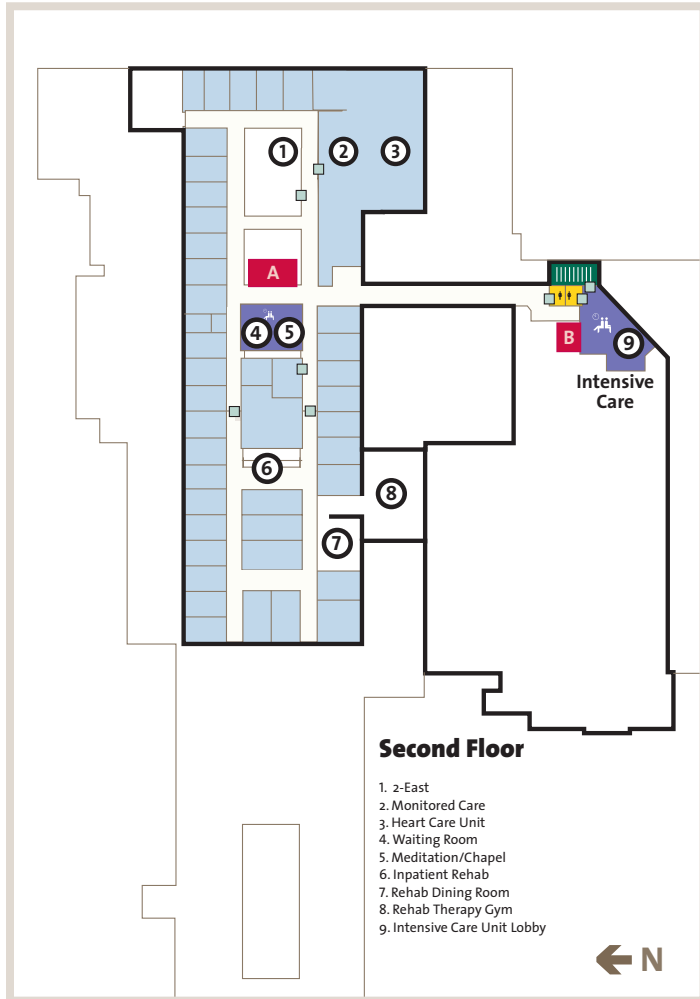

To Registration

Our main registration area is located near the main entrance of the hospital. To reach it from the Emergency, Same Day Surgery, ICU or Maternity lobbies, take Elevator B to the first floor. Follow the public hallway to Elevator A. Turn right past the elevator, then left. Registration will be on your left.

Outpatient Testing

Patient Access Representatives work with Registration staff to assure that an escort can direct you to your destination when coming to SOMC for an outpatient test. Specific directions for individual destinations will be provided in the event you do not prefer an escort.

To the Meditation/Chapel Room

Our meditation/chapel room is located on the second floor, adjacent to the waiting room across from Elevator A.

To the Prenatal Education Classrooms

Classrooms for prenatal education and lactation consultation are in the main corridor on the third floor leading from Maternity to the rest of the hospital. To reach them, take Elevator B to the third floor and turn right down the public hallway. The classrooms will be on your left; or take Elevator A to the third floor, turn left and proceed up the hallway. The classrooms will be on your right.

Restricted Hours

For the safety and security of our patients and visitors, the hospital doors will be locked from 10 p.m. to 5 a.m. nightly. Access to the hospital during those hours is available through the Emergency Dept. entrance. All visitors during these nightly hours are provided a visitor pass. Please ask the attending Security Officer in the Emergency Dept. for assistance.

South Campus

1248 Kinneys Lane, Portsmouth, OH | 740|356-5000

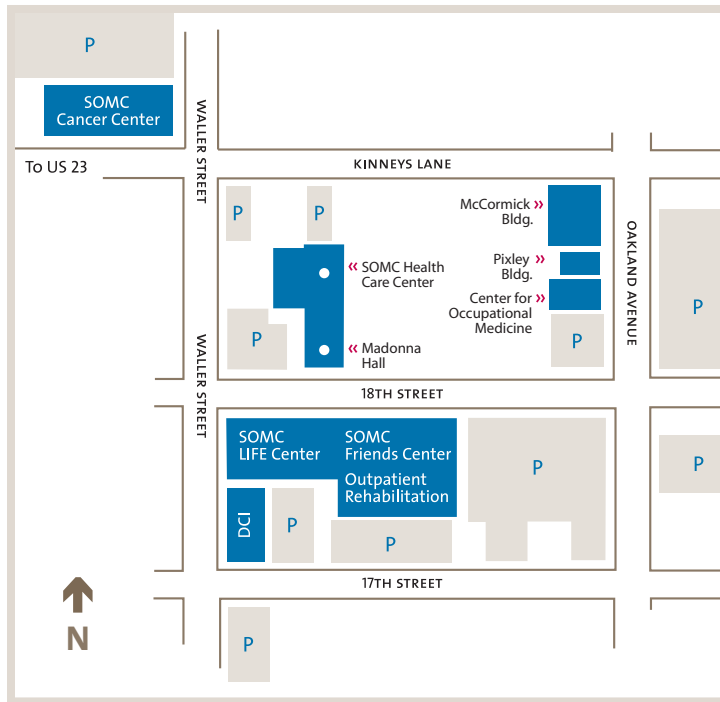

Building Directory

McCormick Building (Former Building A)

SOMC Anticoagulation Clinic
William Shannon, DDS

Occupational Medicine Building (Fmr. Bldg. C)

SOMC Employment Office
SOMC Occupational Medicine
Hong S. Kang, MD

Pixley Building (Fmr. Bldg. B)

Adenike Moore, MD
Kendall Stewart, MD

Madonna Hall

Community Services for the Deaf and Hard of Hearing

Key Destinations on South Campus

SOMC Cancer Center (including Lithotripsy and PET Scan)
SOMC Center for Occupational Medicine
Community Services for the Deaf and Hard of Hearing
DCI Building (Dialysis Clinic, Inc., SOMC Cashier Office)
SOMC Employment Office
SOMC Friends Community Center
SOMC Health Care Center
SOMC LIFE Center
SOMC Outpatient Rehabilitation

Driving Directions to South Campus

From North or South

Coming south or north on US 23, onto Kinneys Lane (if you are coming north on US 23, turn right; if coming south, turn left). Travel one block on Kinneys Lane and turn right onto Waller Street, turn left on 18th Street for parking at the rear of the campus.

From East or West

If you are coming on US 52, turn on US 23 North, turn right on Kinneys Lane, turn right at the first stop sign onto Waller Street, turn left at 18th Street for parking. The SOMC Health Care Center is on the left. The SOMC LIFE Center and Friends Community Center will be on your right at 1202 18th St.

East Campus

2201 25th Street, Portsmouth, OH

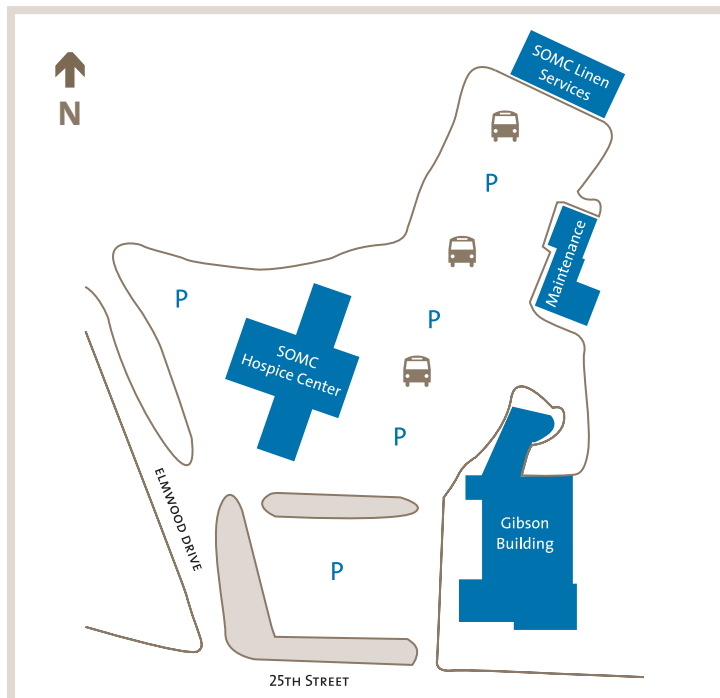

Building Directory

Gibson Building

Community Health
Community Relations
Conference Room
SOMC Hospice
Staff Development
Transcriptionists

SOMC Hospice Center

SOMC Linen Services
East Campus Maintenance

Key Destinations on East Campus

Community Relations
SOMC Hospice
SOMC Hospice Center
SOMC Linen Services
Staff Development

Driving Directions to East Campus

From North or South

When coming north or south on US 23, within the city limits, turn onto Coles Boulevard and proceed to 25th Street, turn left (east) and pass Grandview Avenue, Summit on the right and Ka-Lyn on the left, Elmwood Drive and turn left into the parking lot.

From East or West

Coming from US 52 East or West, turn on US 23 North, turn right onto Coles Boulevard. Proceed to 25th Street, turn left (east) and pass Grandview Avenue, Summit on the right and Ka-Lyn on the left, Elmwood Drive and turn left into the parking lot.

Driving Directions To SOMC Satellite Facilities

SOMC Lucasville Family Practice

10 Thomas Hollow Road
Lucasville, OH 45648
740|259-5699
Terry A. Johnson, DO

Driving directions from Portsmouth: take US 23 north toward Lucasville. At the second traffic light in Lucasville, turn right, go under the railroad overpass and make an immediate left onto Fairground Road. Turn right onto Thomas Hollow Road. The office is the first building on the right.

SOMC Minford Family Practice

8792 State Route 335
Minford, OH 45653
740|820-2141
Cynthia G. Hamm, MD

Driving directions from Portsmouth: take US 23 north toward Lucasville. At the second traffic light in Lucasville, turn right, go under the railroad overpass and proceed east on Lucasville-Minford Road approximately seven miles. Cross the railroad tracks and turn right onto Ohio 335. At the next intersection (four-way stop) go straight. The Minford Family Practice is on the left.

SOMC Sciotoville Family Practice

5611 Gallia Street
Sciotoville, OH 45662
Robert E. Newman, MD
740| 776-2146
Christopher M. Woodard, MD
740| 776-0795

Driving directions from Portsmouth: take US 52 east through and beyond New Boston. Take the Sciotoville Exit ramp on the right, take a slight right and stay straight on Gallia Street. Proceed through the four-way stop and the Sciotoville Family Practice will be on the left at 5611 Gallia St.

SOMC South Shore Family Practice

276 Biggs Lane
South Shore, KY 41175
606|932-2444
Roy A. Gill, MD

Driving directions from Portsmouth: proceed south on US 23 on Chillicothe Street and cross the US Grant Bridge into Kentucky. Turn left staying on US 23 south, proceed 3.6 miles, turn left onto Biggs Lane. The South Shore Family Practice is at 276 Biggs Lane.

continued on next page

Driving Directions To SOMC Satellite Facilities (cont.)

SOMC South Webster Family Practice

404 Jackson Street
South Webster, OH 45682
740|778-3650
John L. Oehler, DO

Driving directions from Portsmouth: proceed east on US 52, through New Boston and past Sciotoville. Take the Ohio 140 exit and proceed 11 miles into South Webster, turn left onto Jackson Street. The South Webster Family Practice will be on the right at 404 Jackson St.

SOMC LIFE Centers in Lucasville and Wheelersburg

SOMC LIFE Center Lucasville

10617 U.S. Route 23
Lucasville, OH 45648
740|259-5433

Driving directions from Portsmouth: proceed north on US 23 toward Lucasville. At the first traffic light in Lucasville turn left and make an immediate right into the LIFE Center parking lot.

SOMC LIFE Center Wheelersburg

8430 Hayport Road
Wheelersburg, OH 45694
740|574-4022

Driving directions from Portsmouth: proceed east on US 52, through New Boston and past Sciotoville. Take the Wheelersburg exit ramp on right, turn left onto River Road, turn right at the first traffic light onto Ohio River Road. At the next traffic light turn left onto Hayport Road. The LIFE Center will be on the right at 8430 Hayport Road.

SOMC Wheelersburg Facilities

SOMC Urgent Care Center

8770 Ohio River Road
Wheelersburg, OH 45694
740|574-9090
Timothy Mynes, DO

Driving directions from Portsmouth: proceed east on US 52, through New Boston and past Sciotoville. Take the Wheelersburg exit ramp on right, turn left onto River Road, turn right at the first traffic light onto Ohio River Road. Proceed through the next traffic light. The Urgent Care Center will be on the left at 8770 Ohio River Road.

continued on next page

Driving Directions To SOMC Satellite Facilities (cont.)

SOMC Wheelersburg Outpatient Rehab Services

613 Center Street, Suite D
Wheelersburg, OH 45694
740|574-8189

Driving directions from Portsmouth: proceed east on US 52, through New Boston and past Sciotoville. Take the Wheelersburg exit ramp on right, turn left onto River Road, go straight at the first and second traffic lights. Rehab Services is part of the Medical Plaza on the left at 613 Center St.

SOMC Medical Plaza

613 Center Street
Wheelersburg, OH 45694
740|574-8150
Jacqueline G Nickell, DDS

Driving directions from Portsmouth: proceed east on US 52, through New Boston and past Sciotoville. Take the Wheelersburg exit ramp on right, turn left onto River Road, go straight at the first and second traffic lights. The Medical Plaza is on the left at 613 Center St.

Wheelersburg Offices at Bulwer & Gallia

Pediatrics

536 Bulwer Street
Wheelersburg, OH 45694
740|574-1903
John Turjoman, MD

Vision Care

536 Bulwer Street
Wheelersburg, OH 45694
740|574-4745
Timothy Horner, OD

Driving directions from Portsmouth: proceed east on US 52, through New Boston and past Sciotoville. Take the Wheelersburg exit ramp on right, turn left onto River Road, go straight at the first traffic light. Turn right at the second light onto Gallia Street. Turn right onto Bulwer and the office building will be on the left at 536 Bulwer Street.

Wheelersburg Office at Duis Street

351 Duis Street
Wheelersburg, OH 45694
740|574-1500
Mouhib Kalo, MD

Driving directions from Portsmouth: proceed east on US 52, through New Boston and past Sciotoville. Take the Wheelersburg exit ramp on right, turn left onto River Road, turn left at the first traffic light onto Ohio River Road. Turn right onto Duis Street and the office is at 351 Duis St.